

COOL-FIT PE Plus Bend 45° PN10

Model:

- Pre-insulated PE100 SDR 17 metric
- Outer jacket impact resistant. Color: black
- Insulation made from PUR

d (mm)	D (mm)	PN (bar)	Code	x (mm)	L (mm)	closest inch (inch)
250	355	10	738 053 121	123	440	10
280	400	10	738 053 122	126	460	10
315	450	10	738 053 123	133	535	12
355	500	10	738 053 124	145	620	14
400	560	10	738 053 175	147	650	16
450	630	10	738 053 176	163	680	18

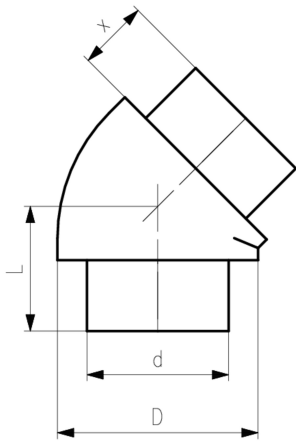

The technical data are not binding. They neither constitute expressly warranted characteristics nor guaranteed properties nor a guaranteed durability. They are subject to modification. Our General Terms of Sale apply.

Georg Fischer Piping Systems Ltd, Postfach, CH-8201 Schaffhausen/Switzerland

Phone +41 -(0)52-631 1111

e-mail: info.ps@georgfischer.com

Internet: <http://www.gfps.com>