



## Flange adaptor PVC-C Combined jointing face flat and serrated metric

### Model:

- Gasket: flat gasket EPDM code no. 748 400 306-320
- Flange: code no. 727 700 406-420, 727 700 206-220, 721 700 006-020
- Gasket: profile flange gasket EPDM code no. 748 440 706-720, FPM code no. 749 440 706-720

### Note:

\* bevel on pipe may be needed if used with butterfly valve type 037/038/039

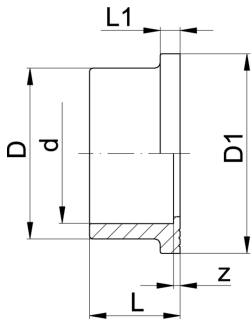

	d [mm]	DN [mm]	PN [bar]	Code	SP	Weight [kg]	z [mm]	D [mm]	D1 [mm]	L [mm]	L1 [mm]
	20	15	16	<b>723 790 106</b>	10	0.011	3	27	34	21	6
	25	20	16	<b>723 790 107</b>	10	0.018	3	33	41	24	7
	32	25	16	<b>723 790 108</b>	10	0.027	3	41	50	27	7
	40	32	16	<b>723 790 109</b>	10	0.032	3	50	61	30	8
	50	40	16	<b>723 790 110</b>	10	0.054	3	61	73	34	8
	63	50	16	<b>723 790 111</b>	10	0.097	3	76	90	41	9
	75	65	16	<b>723 790 112</b>	10	0.168	3	91	106	47	10
	90	80	16	<b>723 790 113</b>	10	0.265	5	108	125	56	11
	110	100	16	<b>723 790 114</b>	10	0.441	5	131	150	66	12
*	160	150	16	<b>723 790 117</b>	12	1.139	5	188	213	91	16
*	200	200	10	<b>723 790 119</b>	2	1.630	6	224	250	112	24
	225	200	10	<b>723 790 120</b>	2	1.860	6	248	274	125	25

The technical data are not binding. They neither constitute expressly warranted characteristics nor guaranteed properties nor a guaranteed durability. They are subject to modification. Our General Terms of Sale apply.

Georg Fischer Piping Systems Ltd, Postfach, CH-8201 Schaffhausen/Switzerland  
 Phone +41 -(0)52-631 1111  
 e-mail: [info.ps@georgfischer.com](mailto:info.ps@georgfischer.com)  
 Internet: <http://www.gfps.com>