

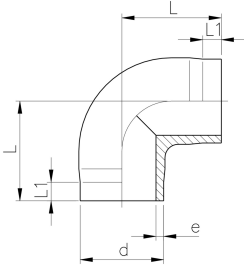

## PROGEF Standard elbow 90° S5/SDR11

### Model:

- Material: PP-H
- Conventional butt-welding according to DVS 2207 part 11
- IR = Infrared-(IR Plus®) compatible. Choose fusion parameters: PP-H



d [mm]	FM	Code	Weight [kg]	L [mm]	L1 [mm]	e [mm]
20	IR	<b>727 108 506</b>	0.008	38	25	1.9
25	IR	<b>727 108 507</b>	0.012	42	26	2.3
32	IR	<b>727 108 508</b>	0.022	46	27	2.9
40	IR	<b>727 108 509</b>	0.045	51	22	3.7
50	IR	<b>727 108 510</b>	0.080	58	23	4.6
63	IR	<b>727 108 511</b>	0.138	66	21	5.8

The technical data are not binding. They neither constitute expressly warranted characteristics nor guaranteed properties nor a guaranteed durability. They are subject to modification. Our General Terms of Sale apply.

Georg Fischer Piping Systems Ltd, Postfach, CH-8201 Schaffhausen/Switzerland  
Phone +41 -(0)52-631 1111  
e-mail: [info.ps@georgfischer.com](mailto:info.ps@georgfischer.com)  
Internet: <http://www.gfps.com>