



PROGEF Standard bend 90° S5/SDR11

Model:

- Material: PP-H
- Conventional butt-welding according to DVS 2207 part 11
- IR = Infrared-(IR Plus®) compatible. Choose fusion parameters: PP-H

* Material:PP-R

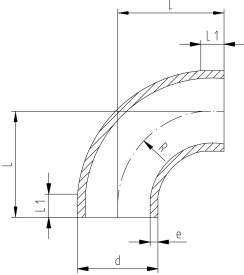

	d [mm]	FM	Code	Weight [kg]	L [mm]	L1 [mm]	R [mm]	e [mm]
	20	IR	727 018 606	0.008	38	23	15	1.9
	25	IR	727 018 607	0.013	42	23	19	2.3
	32	IR	727 018 608	0.022	46	22	24	2.9
	40	IR	727 018 609	0.040	51	21	30	3.7
	50	IR	727 018 610	0.067	58	21	37	4.6
	63	IR	727 018 611	0.117	66	21	45	5.8
	75	IR	727 018 612	0.232	100	20	90	6.8
	90	IR	727 018 613	0.337	100	20	90	8.2
	110	IR	727 018 614	0.701	141	25	130	10.0
	125	IR	727 018 615	0.818	125	28	116	11.4
	140	IR	727 018 616	1.148	140	33	131	12.7
	160	IR	727 018 617	1.699	160	33	151	14.6
	180	IR	727 018 618	2.394	180	33	171	16.4
	200	IR	727 018 619	3.264	200	33	190	18.2
	225	IR	727 018 620	4.535	220	33	210	20.5
	250		727 018 521	6.351	256	48	232	22.7
	280		727 018 522	9.398	286	48	262	25.4
	315		727 018 523	12.959	321	48	297	28.6
*	355		727 018 574	19.400	385	38	355	32.2
*	400		727 018 575	28.453	438	41	400	36.3

The technical data are not binding. They neither constitute expressly warranted characteristics nor guaranteed properties nor a guaranteed durability. They are subject to modification. Our General Terms of Sale apply.

Georg Fischer Piping Systems Ltd, Postfach, CH-8201 Schaffhausen/Switzerland
 Phone +41 -(0)52-631 1111
 e-mail: info.ps@georgfischer.com
 Internet: <http://www.gfps.com>