



## PROGEF Standard reducer S5/SDR11

### Model:

- Material: PP-H
- Conventional butt-welding according to DVS 2207
- IR = Infrared-(IR Plus®) compatible. Choose fusion parameters: PP-H

<sup>1</sup> Material: PP-R

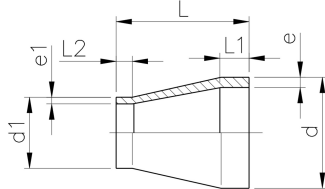

	d [mm]	d1 [mm]	FM	Code	Weight [kg]	e [mm]	e1 [mm]	L [mm]	L1 [mm]	L2 [mm]
	25	20	IR	<b>727 908 537</b>	0.007	2.3	1.9	50	20	20
	32	20	IR	<b>727 908 542</b>	0.010	2.9	1.9	50	20	20
	32	25	IR	<b>727 908 541</b>	0.010	2.9	2.3	50	20	20
	40	20	IR	<b>727 908 548</b>	0.016	3.7	1.9	58	20	23
	40	25	IR	<b>727 908 547</b>	0.016	3.7	2.3	55	20	20
	40	32	IR	<b>727 908 546</b>	0.018	3.7	2.9	55	20	20
	50	25	IR	<b>727 908 554</b>	0.024	4.6	2.3	60	20	20
	50	32	IR	<b>727 908 553</b>	0.027	4.6	2.9	60	20	20
	50	40	IR	<b>727 908 552</b>	0.030	4.6	3.7	60	20	20
	63	32	IR	<b>727 908 560</b>	0.043	5.8	2.9	65	20	20
	63	40	IR	<b>727 908 559</b>	0.047	5.8	3.7	65	20	20
	63	50	IR	<b>727 908 558</b>	0.051	5.8	4.6	65	20	20
	75	40	IR	<b>727 908 566</b>	0.062	6.8	3.7	68	20	20
	75	50	IR	<b>727 908 565</b>	0.071	6.8	4.6	65	20	20
	75	63	IR	<b>727 908 564</b>	0.075	6.8	5.8	65	20	20
	90	63	IR	<b>727 908 571</b>	0.115	8.2	5.8	75	22	19
	90	75	IR	<b>727 908 570</b>	0.130	8.2	6.8	75	22	19
	110	75	IR	<b>727 908 577</b>	0.215	10.0	6.8	90	28	18
	110	90	IR	<b>727 908 576</b>	0.225	10.0	8.2	90	28	30
	125	110	IR	<b>727 908 580</b>	0.335	11.4	10.0	100	32	30
	140	110	IR	<b>727 908 585</b>	0.423	12.7	10.0	110	33	29
	140	125	IR	<b>727 908 584</b>	0.462	12.7	11.4	110	34	30
	160	110	IR	<b>727 908 590</b>	0.586	14.6	10.0	120	39	27
	160	140	IR	<b>727 908 588</b>	0.647	14.6	12.7	120	40	35
	180	90	IR	<b>727 908 978</b>	0.968	16.4	8.8	157	45	22
	180	110	IR	<b>727 908 977</b>	0.987	16.4	10.0	157	45	28
	180	125	IR	<b>727 908 976</b>	0.890	16.4	11.4	136	45	32
	180	140	IR	<b>727 908 975</b>	0.917	16.4	12.7	136	45	35
	180	160	IR	<b>727 908 974</b>	1.031	16.4	14.6	136	45	35
	200	160	IR	<b>727 908 592</b>	1.149	18.2	14.6	145	50	40
	200	180	IR	<b>727 908 979</b>	1.350	18.2	16.4	151	50	45
	225	110	IR	<b>727 908 595</b>	1.485	20.5	10.0	160	55	35
	225	160	IR	<b>727 908 596</b>	1.563	20.5	14.6	160	55	40
	225	180	IR	<b>727 908 983</b>	1.893	20.5	16.4	171	55	45
	225	200	IR	<b>727 908 597</b>	1.723	20.5	18.2	160	55	50
	250	160		<b>727 908 990</b>	1.483	22.7	14.6	194	60	55
	250	225		<b>727 908 987</b>	2.592	22.7	20.5	182	60	55
1	280	225		<b>727 908 992</b>	1.854	25.4	20.5	105	30	20
1	280	250		<b>727 908 991</b>	1.311	25.4	22.7	70	30	18
1	315	225		<b>727 908 997</b>	2.857	28.6	20.5	130	30	20
1	315	250		<b>727 908 996</b>	3.500	28.6	22.7	100	30	20
1	315	280		<b>727 908 995</b>	1.577	28.6	25.4	63	30	18
1	355	250		<b>727 908 963</b>	5.490	32.3	22.7	245	90	60
1	355	280		<b>727 908 962</b>	5.462	32.2	25.4	245	90	70
1	355	315		<b>727 908 961</b>	3.700	32.2	28.6	245	90	80
1	400	315		<b>727 908 966</b>	5.300	36.3	28.6	260	95	80
1	400	355		<b>727 908 965</b>	4.800	36.3	32.2	260	95	90
	450	280		<b>727 908 960</b>	9.000	40.9	25.4	230	60	70
	450	315		<b>727 908 948</b>	8.000	40.9	28.6	230	60	80
	450	355		<b>727 908 950</b>	7.400	40.9	32.2	230	60	90
	450	400		<b>727 908 951</b>	6.000	40.9	36.3	230	60	95

# Datasheet

valid from: 9/1/15

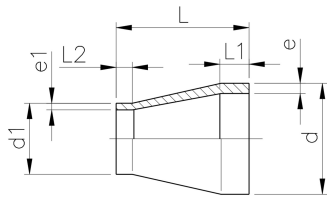

	d [mm]	d1 [mm]	FM	Code	Weight [kg]	e [mm]	e1 [mm]	L [mm]	L1 [mm]	L2 [mm]	
	500	315		<b>727 908 953</b>	12.000	45.4	28.6	230	60	80	
	500	355		<b>727 908 954</b>	10.800	45.4	32.2	230	60	90	
	500	400		<b>727 908 956</b>	10.000	45.4	36.3	230	60	95	
	500	450		<b>727 908 964</b>	8.300	45.4	40.9	230	60	60	

The technical data are not binding. They neither constitute expressly warranted characteristics nor guaranteed properties nor a guaranteed durability. They are subject to modification. Our General Terms of Sale apply.

Georg Fischer Piping Systems Ltd, Postfach, CH-8201 Schaffhausen/Switzerland  
 Phone +41 -(0)52-631 1111  
 e-mail: [info.ps@georgfischer.com](mailto:info.ps@georgfischer.com)  
 Internet: <http://www.gfps.com>