

MULTI/JOINT® 3007 Plus Wide Range Coupling, restraint, Uni/Fiksers

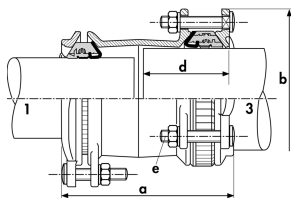

Model:

- Suitable for all kinds of pipe material
- Suitable for water and gas
- Ductile cast iron GGG45 body and clamping ring(s), acc. to EN-GJS-450-10
- RESICOAT® epoxy powder coating, according to GSK standards and EN 14901
- NBR or EPDM gasket, NBR acc. to EN 682 (-5°C up to +50°C), EPDM acc. to EN 681-1 (0°C up to +50°C)
- Angular deflection of max. 8° per socket at installation (based on the middle of the range)
- Stainless steel A4 quality (AISI 316) Uni/Fiksers
- Stainless steel A2 quality (AISI 304) or A4 quality (AISI 316) bolts, nuts and washers
- For restraint versions, on plastic pipes, the use of an insert stiffener (see accessories) is mandatory, check our technical information
- Hygiene protection included DN50 - DN600
- * MULTI/JOINT® 3000 Plus sizes DN425 and DN475 available Q1 2017. Please consult Georg Fischer Waga N.V. for availability.

DN (mm)	Range 1 (mm)	Range 3 (mm)	NBR / A2 Code	EPDM / A2 Code	Weight (kg)
50	46 - 71	46 - 71	709 305 210	709 305 610	4.800
65	63 - 90	63 - 90	709 305 212	709 305 612	5.600
80	84 - 105	84 - 105	709 305 214	709 305 614	7.200
100	104 - 132	104 - 132	709 305 216	709 305 616	9.400
125	132 - 155	132 - 155	709 305 218	709 305 618	12.000
150	154 - 192	154 - 192	709 305 220	709 305 620	14.800
200	192 - 232	192 - 232	709 305 224	709 305 624	28.600
225	230 - 268	230 - 268	709 305 226	709 305 626	33.400
250	267 - 310	267 - 310	709 305 228	709 305 628	40.000
300	315 - 356	315 - 356	709 305 232	709 305 632	51.500
350	352 - 393	352 - 393	709 305 236	709 305 636	61.200
400	392 - 433	392 - 433	709 305 240	709 305 640	73.200
* 425	432 - 464	432 - 464	709 305 242	709 305 642	91.800
450	450 - 482	450 - 482	709 305 272	709 305 672	98.100
* 475	481 - 513	481 - 513	709 305 273	709 305 673	98.300
500	500 - 532	500 - 532	709 305 274	709 305 674	106.000
550	548 - 580	548 - 580	709 305 276	709 305 676	115.600
600	605 - 637	605 - 637	709 305 278	709 305 678	136.800

DN (mm)	NBR / A4 Code	EPDM / A4 Code	Weight (kg)
50	709 305 010	709 305 310	4.800
65	709 305 012	709 305 312	5.600
80	709 305 014	709 305 314	7.200
100	709 305 016	709 305 316	9.400
125	709 305 018	709 305 318	12.000
150	709 305 020	709 305 320	14.800
200	709 305 024	709 305 324	28.600
225	709 305 026	709 305 326	33.400
250	709 305 028	709 305 328	40.000
300	709 305 032	709 305 332	51.500
350	709 305 036	709 305 336	61.200
400	709 305 040	709 305 340	73.200
* 425	709 305 042	709 305 342	91.800
450	709 305 072	709 305 372	98.100
* 475	709 305 073	709 305 373	98.300
500	709 305 074	709 305 374	106.000
550	709 305 076	709 305 376	115.600
600	709 305 078	709 305 378	136.800

Data sheet

valid from: 11/14/16

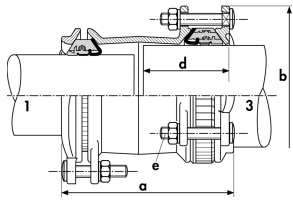

DN (mm)	a (mm)	b (mm)	d (mm)	e (mm)	PN Water (bar)	PN Gas (bar)	
50	209 - 233	164	95	3xM12	16.0	8	
65	220 - 250	186	100	3xM12	16.0	8	
80	234 - 262	204	115	3xM12	16.0	8	
100	230 - 268	236	110	3xM16	16.0	8	
125	246 - 282	264	120	4xM16	16.0	8	
150	242 - 298	304	120	4xM16	16.0	8	
200	297 - 351	354	140	6xM16	16.0	8	
225	342 - 404	386	145	6xM20	16.0	8	
250	354 - 424	432	170	6xM20	16.0	8	
300	356 - 426	490	170	8xM20	16.0	8	
350	504 - 588	534	245	8xM20	10.0	5	
400	562 - 648	574	275	10xM20	10.0	5	
*	425	530 - 580	623	275	10xM20	10.0	5
	450	530 - 580	641	275	10xM20	10.0	5
*	475	530 - 580	672	275	10xM20	10.0	5
	500	530 - 580	691	275	10xM20	10.0	5
	550	530 - 580	739	275	12xM20	10.0	5
	600	530 - 580	796	275	14xM20	10.0	5

The technical data are not binding. They neither constitute expressly warranted characteristics nor guaranteed properties nor a guaranteed durability. They are subject to modification. Our General Terms of Sale apply.

Georg Fischer Piping Systems Ltd, Postfach, CH-8201 Schaffhausen/Switzerland

Phone +41 -(0)52-631 1111

e-mail: info.ps@georgfischer.com

Internet: <http://www.gfps.com>