

## Tee 90° pre-insulated ABS metric

### Model:

- Insulation made from PUR
- Outer jacket impact resistant. Color: black
- Compact design

Connecting dimensions = Pipe outer diameter

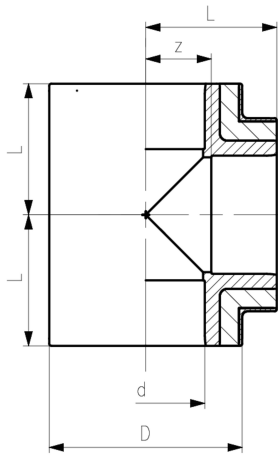

d (mm)	PN (bar)	D (mm)	Code	SP	Weight (kg)	L (mm)	closest inch (inch)	z (mm)
250	6	355	<b>738 201 121</b>	1	14.654	263	10	132
280	6	400	<b>738 201 122</b>	1	21.000	298	10	152
315	6	450	<b>738 201 123</b>	1	27.000	332	12	160

The technical data are not binding. They neither constitute expressly warranted characteristics nor guaranteed properties nor a guaranteed durability. They are subject to modification. Our General Terms of Sale apply.

Georg Fischer Piping Systems Ltd, Postfach, CH-8201 Schaffhausen/Switzerland

Phone +41 -(0)52-631 1111

e-mail: [info.ps@georgfischer.com](mailto:info.ps@georgfischer.com)

Internet: <http://www.gfps.com>